

Head Office:
Dixon Kelley Estate Agents
1 Penn Court
Station Road, West Moors
Dorset. BH22 0JJ

DORSET PARK HOMES

DRAFT

www.dorsetparkhomes.com

Telephone: 01202 877511

5 Hillbury Park, Hillbury Road, Alderholt, Fordingbridge. SP6 3BW



Spacious Park Home with Farmland Views

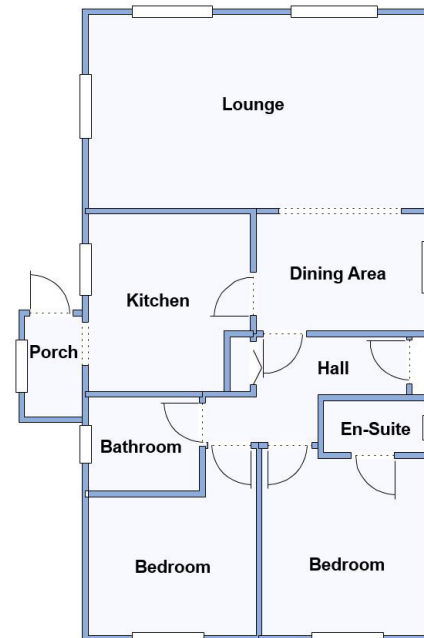

This drawing has been prepared for diagrammatic purpose only. Not to scale.

2-Bedroom Park Home - approx 36' x 20'

Accommodation & approximate room dimensions:

- Wonderland 'Dorset' Park Home approx 1997
- Hall: Linen cupboard. Hatch to loft space.
- Lounge: approx 19'5" x 11'2". Feature fireplace. Bay window with farmland views.
- Dining Area: approx 9'9" x 6'9"
- Kitchen: approx 10'3" x 9'4". Range of floor and wall cupboards. Built-in oven, hob & cooker hood. Space for fridge/freezer & washing machine. Door to Side Porch.
- Bedroom 1: approx 10'2" x 9'6". Fitted wardrobes.
- En-Suite Shower Room
- Bedroom 2: approx 9'6" x 8'. Built-in wardrobes.
- Bathroom: Panelled bath, wash basin & WC.
- Gas Central Heating (system untested)
- PVCu Double-Glazing
- Private Patio Garden with farmland views.
- Parking on Plot
- Age Restriction 45+ Pets Considered
- Popular Residential Park in semi-rural location near to local amenities and within a short drive to Fordingbridge town centre.

'Pet Friendly' Park



Pitch Fee: approx £216.38 per month

Subject to Annual Review

Council Tax Band: 'A'

Tenure: 1983 Mobile Homes Act Agreement

Price: £148,000

VIEWING STRICTLY BY APPOINTMENT WITH THE VENDOR'S AGENT Dorset Park Homes 01202 877511

IMPORTANT NOTE: These particulars are believed to be correct but their accuracy is not guaranteed. They do not form part of any contract. Nothing in these particulars shall be deemed to be a statement that the property is in good structural condition or otherwise, nor that any of the services, appliances, equipment or facilities are in good working order or have been tested. Purchasers should satisfy themselves on such matters prior to purchase Ref.W04751

The recommended specialist in Park Home sales
Partner: Simon Dixon

